

INSTRUCTION MANUAL

RK4203 MICRO BURNER

The unit does not contain any butane gas when purchased. Please follow below to make it operational.

FUEL FILLING AND REFILLING

- 1 Use pure Butane Gas only.
- 2 Make sure the gas burner is switched off before filling.
- 3 Reverse the unit upside down.
- 4 Insert the butane canister nozzle vertically in a downward motion into the Filling Valve on the bottom of the unit.
- 5 When the fuel begins to overflow, remove the nozzle from the filling valve to stop the filling operation.
It means the unit is full of gas.

IGNITION

After refilling, please allow a few minutes for the fuel to stabilize in the fuel tank and please do not ignite the flame until no liquid form gas is around the refilling valve. Please always place the burner on an even, non-slip surface before ignition.

- 1 Turn the Gas Control Knob to the left (counterclockwise) about 90 degree. (PIC A)
- 2 Press down the Ignition Trigger to light the flame. (PIC B)

FLAME ADJUSTMENT

- After the ignition, turn the Gas Control Knob to the left (counterclockwise) to increase the flame; to the right (clockwise) to decrease the flame.

SHUT OFF

- Turn the Gas Control Knob to right (clockwise) to decrease the flame until the end to shut off the flame. (PIC C)

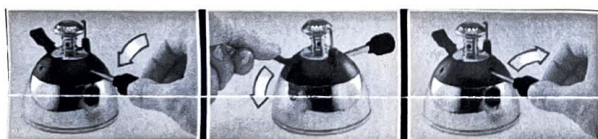

PIC A

PIC B

PIC C

WARNING

- EXTREMELY FLAMMABLE CONTENTS UNDER PRESSURE.
- CONTAINS FLAMMABLE GAS UNDER PRESSURE.
- DO NOT USE NEAR SPARK OR OPEN FLAME.
- DO NOT STORE AT TEMPERATURES ABOVE 50°C or 120°F.
- DO NOT TRY TO DISASSEMBLE OR REPAIR THE UNIT.
- DO NOT TOUCH THE FLAME HEAD WHEN IT IS HOT.
- DO NOT IMMERSE IN WATER.

Important: Read these instructions for use carefully so as to familiarize yourself with the burner before filling gas.

Keep these instructions for future reference.

Use only refined butane gas from the canister for refillable cigarette lighter. It may be hazardous to attempt to fill with other type of gas.

Nominal rate: 56 g/h and 0.75 kW

Use only in a well ventilated area

SAFE INFORMATION

- Do not use an appliance which is leaking, damaged or which does not operate properly
- Use this appliance in a well ventilated location in accordance with national requirements for the supply of combustion air and to avoid the dangerous building up of unburnt gases for appliances not fitted with a flame supervision device.
- The appliance must be operated on a horizontal surface,
- The appliance shall be used away from flammable materials. Keep 300mm as minimum distances from adjacent surfaces.
- The burner shall be refilled in outside or in a well ventilated area.
- Pay attention to sources of ignition, such as naked flames, pilots, electric fires and other people.
- If there is a leak on your appliance, shut it off immediately, and move it outside immediately into a well ventilated flame free location If you wish to check for leaks on your appliance, use soapy water and do it outside. Do not try to detect leaks using a flame.
- **The burner and the bottom of cooker must have at least 30mm distance.**

